

The Immune System

Diseases are often caused by microbes (bacteria, viruses, fungi), external agents (e.g. allergens) or the body itself (e.g. autoimmune diseases, degenerative diseases, cancers).

Our body reacts to these agents through the immune system.

Messengers of our natural immunity, cytokines (e.g. interleukins, interferons, growth factors), circulate at physiological concentrations among the cells to coordinate our defenses.

Micro-immunotherapy

Micro-immunotherapy formulations are used at very high dilutions, to regulate the immune system in order to potentiate and harmonize the body's defenses.

These formulations include cytokines, along with nucleic acids (DNA, RNA, SNA), in homeopathic preparations, to restore the immune function. The sequential order in which the capsules are taken closely reflects the physiological mechanisms at work in the body.

These substances, which are placed under the tongue (oromucosal administration), are taken up by the lymphatic system, which is particularly dense in the sublingual mucosa.

How should you take micro-immunotherapy medicines

You will need to follow several important steps to ensure that you take your micro-immunotherapy medicines correctly.

The blister-pack presentation may differ between formulations, and you should follow the instructions corresponding to your treatment (compare the images to identify your blister pack).

1 - Take the blister pack out of the box

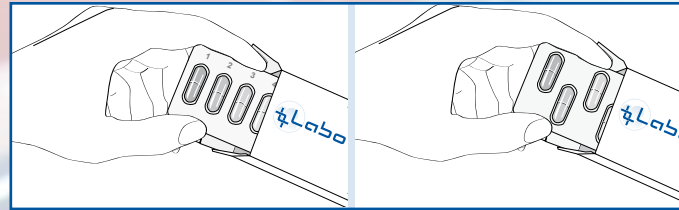

2 - Remove a capsule, following the indicated numerical order

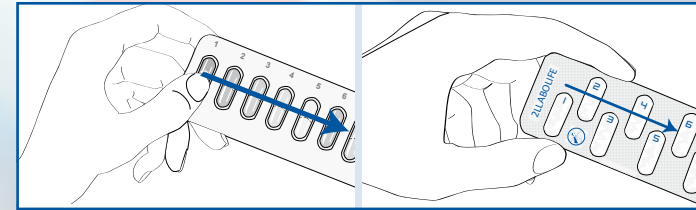

3 - Open the capsule

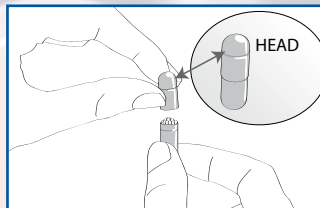

4 - Empty the contents of the capsule under the tongue

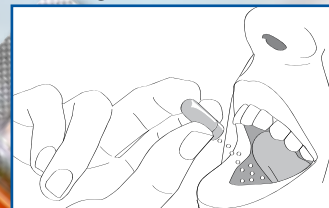

Patients informations

Micro-immunotherapy

When should you take the treatment?

- Preferably before breakfast, in the morning*, on an empty stomach
- If you are taking several Labo'Life treatments at the same time, you should space out intakes over the day. For example, you should take one capsule (for one treatment) in the morning before breakfast, another one (for another treatment) around 11.30 a.m. before lunch, and another (for yet another treatment) at about 3.30 p.m. (you should leave at least two hours between consecutive capsules)
- The treatment should always be taken 15-30 minutes before eating and you should let the granules dissolve completely under the tongue.

*Exception: 2LSLEEPREG should be taken at night, before going to bed, about one hour after the evening meal.

What should you do if you forget to take a capsule?

If you forget to take a capsule before eating, you should take it one hour after the meal.

How should you take the treatment?

- Open the box
- Take out the first blister pack
- Respect the order in which the capsules should be taken (the capsules are numbered from 1 to 10 and you should start with capsule 1 and take each capsule in order, up to capsule 10)
- Take the first capsule out and place it with the head towards the top
- Remove the head by clicking it gently and turning it slowly
- Once the capsule is open, empty its contents under the tongue

- Allow the contents (sugar granules) to dissolve under the tongue. This may take a few minutes
- At the end of the first blister pack, continue the treatment with capsule 1 of the second blister pack, and so on, until no more blister packs remain in the box.

What should I do if I take the capsules in the wrong order?

If you take one of the capsules in the wrong order, continue with the treatment by taking the capsules in order (from 1 to 10) from the last capsule taken.

What is the usual dose?

The usual dose is one capsule per day, in the morning, on an empty stomach. Occasionally, on medical advice, the sequence can be accelerated, but the order of the capsules (1 to 10) must be strictly respected.

What do I need to avoid?

Avoid drinking coffee or tea or using mint-based products before taking your capsules.

How long does micro-immunotherapy treatment usually last?

Micro-immunotherapy treatment may last from a few days to a few months, to provide the immune system with effective support in its battle against diverse illnesses. For some chronic diseases, long-term treatment may be given.

Labo'Life Belgium

Parc scientifique CREALYS
Rue Camille Hubert, 11
5032 Gembloux
BELGIQUE

Tel: + 32 (0) 81 40 87 81
Fax: + 32 (0) 81 40 87 89
info@labolife.com
www.labolife.com

